

Flexible sleeves couplings are available in four materials (EPDM, Neoprene, Hytrel and Urethane) and in three basic constructions. Characteristics of the materials are given below.

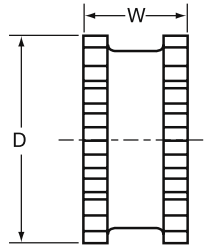

JE, JN



Types JES, JNS

### JE-JES-JN-JNS

J sleeves are molded EPDM rubber (E) or Neoprene (N). They are available in one-piece solid construction (JE, JN) or one-piece split construction (JES, JNS). These sleeves may be used in any Sure-Flex Plus flange within a given size.



E and N  
(Assembled)

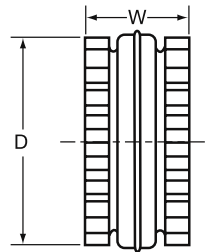

Types E and N  
(Disassembled)

### E-N

These sleeves are of two-piece design with a retaining ring. They are available in either EPDM (E) or Neoprene (N). They may be used with any flange within a given size. Sleeves are shown here assembled and disassembled.



H or U

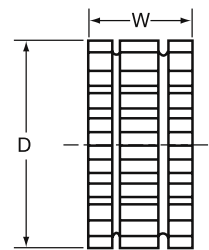

HS

### H-HS-U

H (Hytrel) and U (Urethane) sleeves, designed for high-torque applications, transmit four times as much power as an equivalent EPDM or Neoprene sleeve. Available in one-piece solid construction (H or U) or two-piece split construction (HS), these can be used only with S, C and SC flanges. They cannot be used with J or B flanges or as direct replacements for EPDM or Neoprene sleeves.

### DIMENSIONS (in Inches)

Coupling Size	JE, JES, JN & JNS Sleeves EPDM & Neoprene			E and N Sleeves EPDM & Neoprene			H, U & HS Sleeves Hytrel & Urethane		
	D	W	Weight (lbs.)	D	W	Weight (lbs.)	D	W	Weight (lbs.)
3	1-7/8	1	.06						
4	2-5/16	1-1/4	.10	2-5/16	1-1/4	.11			
5	2-15/16	1-9/16	.20	2-15/16	1-9/16	.25			
6	3-3/4	1-7/8	.40	3-3/4	1-7/8	.49	3-3/4	1-7/8	.44
7	4-11/32	2-3/16	.62	4-11/32	2-3/16	.77	4-11/32	2-3/16	.69
8	5-1/16	2-1/2	1.13	5-1/16	2-1/2	1.4	5-1/16	2-1/2	1.4
9*	6	3	1.46	6	3	2.0	6	3	1.8
10*	7-1/16	3-7/16	2.32	7-1/16	3-7/16	3.2	7-1/16	3-7/16	2.9
11				8-3/16	4	5.1	8-3/16	4	4.5
12				9-9/16	4-11/16	8.1	9-9/16	4-11/16	7.3
13				11-3/16	5-1/2	13.0	11-3/16	5-1/2	11.8
14				13-3/32	6-1/2	21.1	13-3/32	6-1/2	19.3
16				17-29/32	8-3/4	45.3			

Sizes 13 and 14 Hytrel available with HS sleeves only.

\*All 9J and 10J sleeves available in EPDM only. Only sizes available in Urethane.

## B.V. Transmission Industries

Unit 18 , Khyati Industrial Estate,  
Laxmi Nagar, Link Road , Goregaon West,  
Mumbai - 400104, Maharashtra , India

Tel : +91- 22-28762345  
Tel : +91- 22-28767941  
☎ : +91- 93247 18035  
☎ : +91- 98206 92004

email :: sales@bvchains.com  
bvchain@gmail.com  
web:: www.bvchains.com

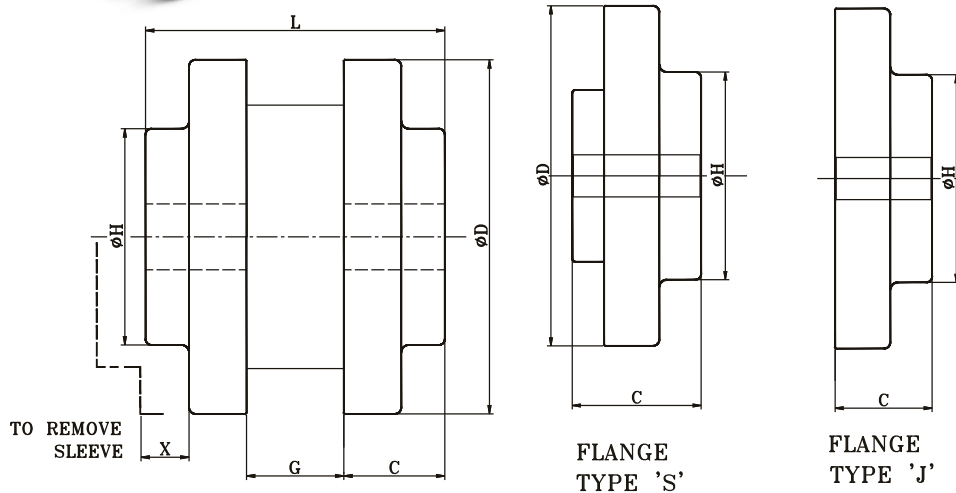

All dimension in mm

Coupling Size	Flange Type	Sleeve Type	kW @ 100 rpm	Rated Torque	Max. Speed	Bore (mm)		Dimensions (mm)					Weight Kg	
				N-m	rpm	P.B.	MAX.	C	D	G	H	L		X
3	J	JE, JES	0.08	7.64	9200	10	22	20	52	9	38	49	16	0.3
4	J		0.15	14.32	7600	13	25	22	63	16	41	60	16	0.5
5	J		0.30	28.65	7600	13	29	26	83	18	48	70	23	1.1
	S									19		71		
6	J		0.52	49.66	6000	16	35	33	102	22	63	88	28	2
	S							44		21		88		
7	S		0.90	85.94	5250	16	48	47	118	25	71	100	34	2.8
8	S		1.34	127.96	4500	19	54	53	138	28	98	112	38	4.8
9	S		2.16	206.26	3750	22	64	61	161	36	98	128	45	7.2
10	S		3.43	327.54	3600	29	73	69	191	41	111	144	51	11.2
11	S	E	5.37	512.80	3600	32	87	87	219	48	133	180	61	18
12	S		8.50	811.69	2800	38	98	104	254	60	146	210	68	28
13	S		13.43	1282.47	2400	51	100	111	299	68	171	235	78	48

- 3 & 4 Flanges are available in Aluminium.
- 5 to 13 Flanges are available in Cast Iron.
- The Weight is approximate with solid Flanges.

## B.V. Transmission Industries

Unit 18 , Khyati Industrial Estate,  
Laxmi Nagar, Link Road , Goregaon West,  
Mumbai - 400104, Maharashtra , India

Tel : +91- 22-28762345  
Tel : +91- 22-28767941  
☎ : +91- 93247 18035  
☎ : +91- 98206 92004

email :: sales@bvchains.com  
bvchain@gmail.com  
web:: www.bvchains.com